



---

## PX108-6 Power Xtender

Use with Digitrax Series 6 1 Amp Decoders **HO Scale**  
Equipped with 6 pin Sound Harness 0.33 F Capacitance  
Use on 10-18V Track Power

---

### Features:

- Keeps locos running during intermittent power interruptions resulting from dirty or bad track.
- Keeps sound from dropping out due to power interruptions.
- Hold up time varies based on actual decoder load & track conditions.
- For use with Digitrax 1 Amp Series 6 decoders.
- Easy to add to Digitrax decoders with 6 pin sound harness.
- 8 ohm 10x18 mm Oval speaker included.
- Plug N' Play installation with no CV configuration required.
- Use on 10-18V track power only

---

### Parts List:

1 PX108-6 Sound Harness 1 Instruction Manual  
1 PX108 Power Xtender

---

### Installation Instructions:

The PX108-6 keeps locomotives running in situations where power to the locomotive is interrupted due to dirty, dead or bad track. The sound harness makes installation easy with no soldering required.

Simply follow these instructions:

1. Remove the existing 6 pin sound harness from the decoder. If already installed in a locomotive, remove the speaker and capacitor from the locomotive. If using additional functions or cam leads, disconnected them, too.
2. Mount the new speaker and the PX108 inside the locomotive in a convenient location.
3. Plug the 6 pin PX108-6 sound harness into the 6 pin socket on the Series 6 decoder. Plug the 2 pin plug from the PX108-6 sound harness into its socket on the PX108 Power Xtender. The plugs are keyed to fit easily into their sockets in only one orientation.
4. Reconnect any function or cam leads if removed previously.
5. Verify that all the connections are secure prior to operating the locomotive.
6. Use on 10-18V track power only.

**Digitrax manuals and instructions are updated periodically. Please visit [www.digitrax.com](http://www.digitrax.com) for the latest version.**



# PX108-6 Power Xtender

Digitrax Power Xtender with 6 pin sound harness

**Figure 1: Removing the original sound harness.**

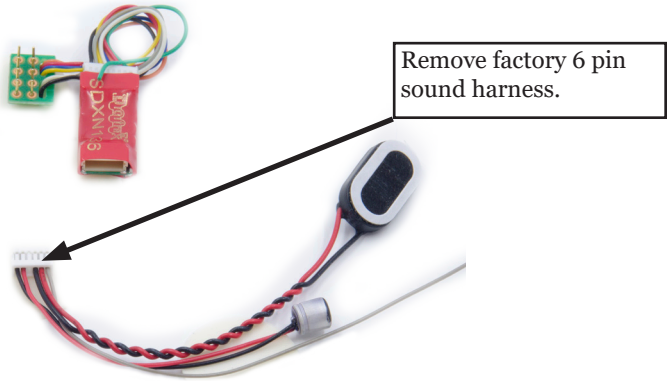

**Figure 2: Installing the PX108-6 Power Xtender**

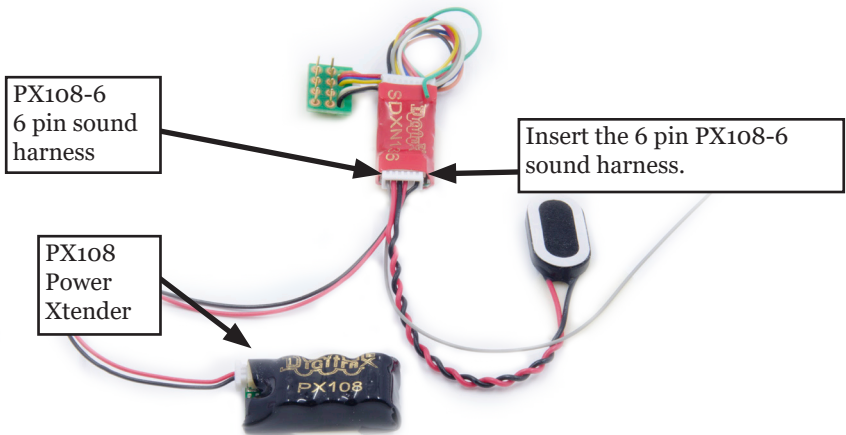

2443 Transmitter Road  
Panama City, FL 32404  
[www.digitrax.com](http://www.digitrax.com)

Made in the USA



Need Support?  
[helpdesk.digitrax.com](mailto:helpdesk.digitrax.com)

PX108-6

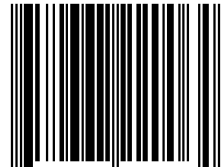

6 52667 22006 4

307-2102-0000